



Studiobeam MSR-575

ORDERCODE 30708



SHOWELECTRONICS FOR PROFESSIONALS

Congratulations!

You have bought a great, innovative product from Showtec.
The Showtec Studiobeam brings excitement to any venue.

You can rely on Showtec, for more excellent lighting products.
We design and manufacture professional light equipment for the entertainment industry.
New products are being launched regularly. We work hard to keep you, our customer, satisfied.
For more information: iwant@showtec.info

You can get some of the best quality, best priced products on the market from Showtec.
So next time, turn to Showtec for more great lighting equipment.
Always get the best -- with Showtec !

Thank you!



Showtec Studiobeam™ Product Guide

Warning	2
Safety-instructions.....	2
Operating Determinations.....	4
Installing the Studiobeam with a Clamp/Hook.....	4
Rigging.....	5
Description	6
Features.....	6
Installation	7
Installing the Lamp	7
Lens Identification.....	7
Installing a Lens.....	8
Removing a Lens.....	8
Color Frame Retaining Clip.....	9
Set Up and Operation	9
Maintenance	10
Cleaning the Rflector.....	10
Changing the Lamp.....	10
Replacing the Fuse.....	10
Troubleshooting	11
No Light.....	11
Product Specifications	12

WARNING



CAUTION!
Keep this device away from rain and moisture!
Unplug mains lead before opening the housing!



**FOR YOUR OWN SAFETY, PLEASE READ THIS USER MANUAL CAREFULLY
BEFORE YOUR INITIAL START-UP!**

SAFETY INSTRUCTIONS

Every person involved with the installation, operation and maintenance of this device has to:

- be qualified
- follow the instructions of this manual



**CAUTION! Be careful with your operations.
With a dangerous voltage you can suffer
a dangerous electric shock when touching the wires!**



Before your initial start-up, please make sure that there is no damage caused by transportation. Should there be any, consult your dealer and do not use the device.

To maintain perfect condition and to ensure a safe operation, it is absolutely necessary for the user to follow the safety instructions and warning notes written in this manual.

Please consider that damages caused by manual modifications to the device are not subject to warranty.

This device contains no user-serviceable parts. Refer servicing to qualified technicians only.

IMPORTANT:

The manufacturer will not accept liability for any resulting damages caused by the non-observance of this manual or any unauthorized modification to the device.

- Never let the power-cord come into contact with other cables! Handle the power-cord and all connections with the mains with particular caution!
- Never remove warning or informative labels from the unit.
- Do not open the device and do not modify the device.
- Do not insert objects into air vents.
- Never use anything to cover the ground contact.
- Never look directly into the light source.
- Never leave any cables lying around.
- Never use the device during thunderstorms, unplug the device immediately.
- Do not connect this device to a dimmerpack.
- Do not switch the device on and off in short intervals, as this would reduce the lamp's life.
- Do not touch the device's housing bare-handed during its operation (housing becomes very hot).
- Do not shake the device. Avoid brute force when installing or operating the device.
- Do not operate the device without a lens installed.
- Only use device indoor, avoid contact with water or other liquids.
- Only operate the fixture after having checked that the housing is firmly closed and all screws are tightly fastened.
- Only operate the device after having familiarized with its functions.
- Avoid flames and do not put close to flammable liquids or gases.
- Always hang the device with the color frame retaining clip in the locked position.
- Always replace the lamp, when it is damaged or deformed due to the heat.
- Always keep case closed while operating.
- Always allow free air space of at least 50 cm around the unit for ventilation.

- Always disconnect power from the mains, when device is not used, before cleaning or when replacing lamp! Only handle the power-cord by the plug. Never pull out the plug by tugging the power-cord.
- Make sure that the device is not exposed to extreme heat, moisture or dust.
- Make sure that the available voltage is not higher than stated on the rear panel.
- Make sure that the power-cord is never crimped or damaged. Check the device and the power-cord from time to time.
- Make sure that no side forces can impact on the truss system.
- Make sure that the core diameter of extension cords and power cords is sufficient for the required power consumption of the device.
- The Studiobeam must be installed onto truss systems via the mounting bracket.
- The cable insert or the female part in the device must never be strained. There must always be sufficient cable to the device. Otherwise, the cable may be damaged which may lead to deadly electrical shocks.
- If the external cable is damaged, it has to be replaced by a qualified technician.
- If the lens or glass is obviously damaged, it has to be replaced. So that its functions are not impaired, due to cracks or deep scratches.
- If device is dropped or struck, disconnect mains power supply immediately. Have a qualified engineer inspect for safety before operating.
- If the device has been exposed to drastic temperature fluctuation (e.g. after transportation), do not switch it on immediately. The arising condensation water might damage your device. Leave the device switched off until it has reached room temperature.
- If your Showtec device fails to work properly, discontinue use immediately. Pack the unit securely (preferably in the original packing material), and return it to your Showtec dealer for service.
- For adult use only. Light effect must be installed out of the reach of children. Never leave the unit running unattended.
- For replacement use lamps and fuses of same type and rating only.
- Allow time to cool down, before replacing lamp.
- The user is responsible for correct positioning and operating of the Studiobeam. The manufacturer will not accept liability for damages caused by the misuse or incorrect installation of this device.
- This device falls under protection class I. Therefore it is essential to connect the yellow/green conductor to earth.
- To ensure the longest and most efficient use of the lamp always wait 15 minutes before re-applying power after a shutdown. Failure to do so could result in premature aging of the lamp and failure to the electronics that drive it.
- Replace the lamp if it becomes defective or worn out, or before usage exceeds the maximum service life.
- During the initial start-up some smoke or smell may arise. This is a normal process and does not necessarily mean that the device is defective.
- Repairs, servicing and electric connection must be carried out by a qualified technician.
- **WARRANTY:** Till one year after date of purchase.



CAUTION ! EYEDAMAGES !.
Avoid looking directly into the light source.
(meant especially for epileptics) !



OPERATING DETERMINATIONS

This device is not designed for permanent operation. Consistent operation breaks will ensure that the device will serve you for a long time without defects.

The minimum distance between light-output and the illuminated surface must be more than 2 meters.

The maximum ambient temperature $t_a = 45^\circ\text{C}$ must never be exceeded.

The relative humidity must not exceed 50 % with an ambient temperature of 45°C .

If this device is operated in any other way, than the one described in this manual, the product may suffer damages and the warranty becomes void.

Any other operation may lead to dangers like short-circuit, burns, electric shock, lamp explosion, crash etc.

You endanger your own safety and the safety of others!

Installing the Studiobeam with a Clamp

You can choose an appropriate mounting clamp (ordercode 70109S / 70109B) from Showtec to securely mount your Studiobeam to the trussing system. Once it has been mounted, adjust the mounting position of the Studiobeam.

1. Tightly fasten the hook to the yoke with the provided yoke bolt and lock washer.
2. Place the clamp on the truss system, then tighten the pipe bolt to secure it.
3. Adjust the desired inclination-angle via the yoke and fix the yoke locking knob.
4. Pull the safety-cable through the hole on the housing and over the truss system. Insert the end in the carabine and tighten the safety screw.

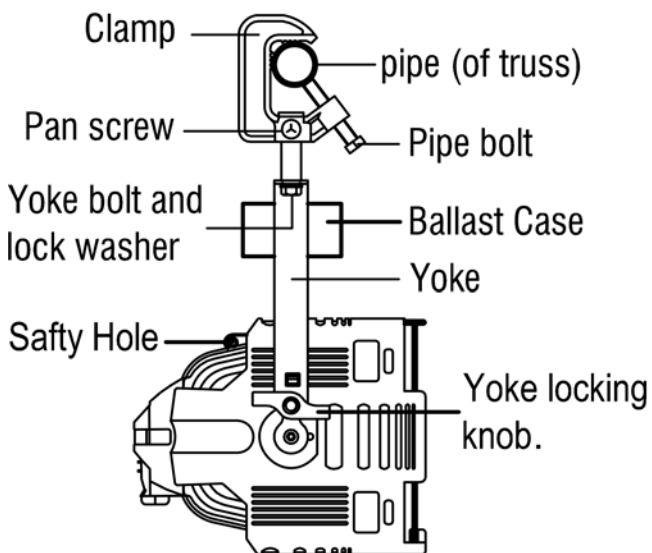

Rigging

Please follow the European and national guidelines concerning rigging, trussing and all other safety issues.

Do not attempt the installation yourself !

Always let the installation be carried out by an authorized dealer !

Procedure:

- If the Studiobeam is lowered from the ceiling or high joists, professional trussing systems have to be used.
- Use a clamp to mount the Studiobeam, with the mounting-bracket, to the trussing system.
- The Studiobeam must never be fixed swinging freely in the room.
- The installation must always be secured with a safety attachment, e.g. an appropriate safety net or safety-cable.
- When rigging, derigging or servicing the Studiobeam, always make sure, that the area below the installation place is blocked and staying in the area is forbidden.

The Studiobeam can be placed on a flat stage floor or mounted to any kind of truss by a clamp.

Improper installation can cause serious damage to people and property !

Connection with the mains

Connect the device to the mains with the power-plug.

Always pay attention, that the right color cable is connected to the right place.

Wire Color	Pin	International
Brown	Fase / Live	L
Blue	Nul / Neutral	N
Yellow / Green	Earth / Ground	

Make sure that the device is always connected properly to the earth!

Description of the device

Features

The Studiobeam MSR-575 is a Studiobeam from Showtec with RGB-Mix.

- Lamp: MSR 575 240V/575W (80915 / 80915O / 80923)
- Electronic ballast ensuring maximum and stable light output
- 4 lenses included: VNSP, NSP, MFL, WFL

Overview



Fig. 1

Installation

Installing the Lamp

The Showtec Studio Beam uses a MSR 575W (ordercode 80915 / 80915O / 80923) bulbs as manufactured by all popular manufacturers. Use only the appropriate lamp for your unit.

Note that, product versions that use other lamps, may be offered in the future. Check your product specification label for information.

Always disconnect from electric mains power supply before changing lamps.

The lamp has to be replaced when it is damaged or deformed due to the heat.

Do not install lamps with a higher wattage! Lamps with a higher wattage generate temperatures the device was not designed for.

Damages caused by non-observance are not subject to warranty.

Procedure :

1. Disconnect from main power supply, and let the Studiobeam cool down for 15 minutes.
2. Loosen the knurled bolt on the back of the lamp housing and pull the housing straight out from the fixture.
3. Read lamp instructions. Do not touch the lamp bulb glass. Oil on hands shortens the lamp life. (If you touch the bulb glass, wipe off the glass with a clean, lint-free towel and rubbing alcohol.).
4. Line up the flat sides of the lamp base with the brackets on either side of the socket (Fig. 3).
5. Insert the lamp pins into the small holes in the lamp socket. Be sure that the lamp is pushed all the way down.
6. Put the lampcover back, by centering it on the reflector and the bolthole. Then fasten the knurled bolt again.

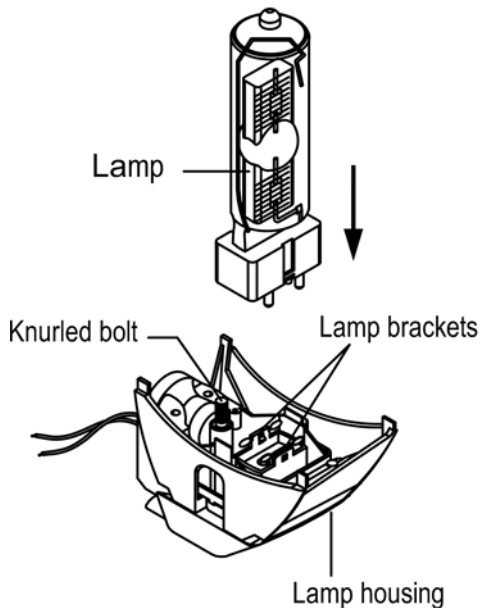

Fig. 3

Lens Identification

Lenses for the Studiobeam are available in 4 versions. The type or beam angle can be identified by the lens texture.

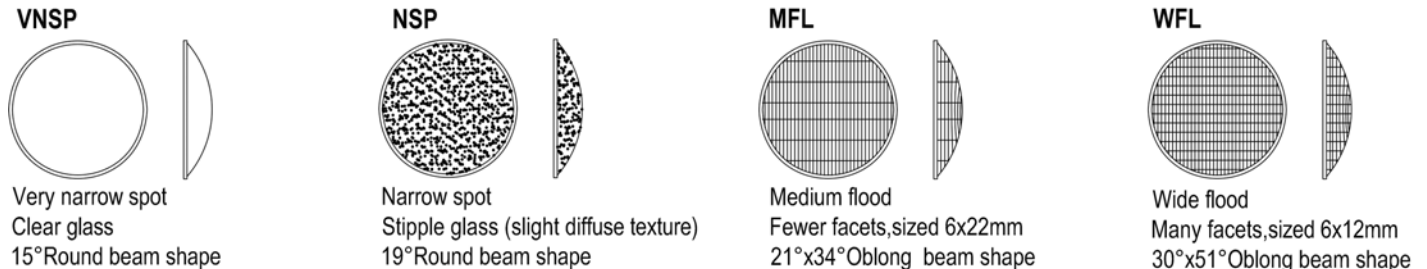

Fig. 4

Installing a Lens

1. When installing the lens, make sure the fixture is on a safe height. Please prevent people from walking under the fixture, when replacing the lens !
2. Position the fixture with the frontside of the unit (Lens Side) facing you. Then tilt its head slightly (Fig. 5).
3. Position the lens rotation ring with the spring clip at the top of the fixture, below the retaining clip.
4. Hold the lens by its edge and position it so, that the convex side faces the back of the fixture (Fig. 6).
Note: Installing the lens with the convex side out, will not only impair the optics, but it will also make removing the lens difficult.
5. From the top of the fixture, slide the lens behind the lens catchers and position its base behind the tabs on the bottom of the lens rotation ring.
6. Gently push the top of the lens inwards, until it snaps behind the spring clip.

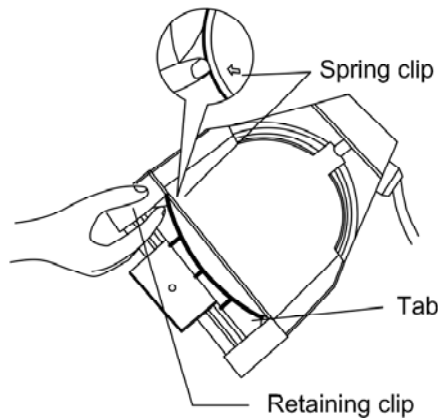

Fig. 5

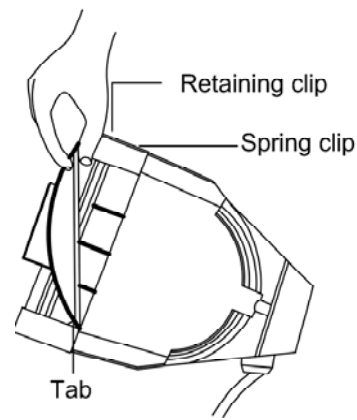

Fig. 6

Removing a Lens

1. Studiobeam lenses get hot while the unit is in operation. Let the fixture cool down before handling the lens.
2. Place the fixture on a flat, stable worksurface.
Pay Attention Never install or remove lenses when the unit is hanging.
3. Position the lens rotation ring with the spring clip at the front of the unit, directly below the retaining clip.
4. Tilt the front of the fixture down at least 45°.
5. Press the spring clip with your fingers to release the lens (Fig. 5).
6. Allow the lens to gently drop forward from under the clip.
7. When the lens drops, remove your finger, allowing the lens to slide forward until it rests on the lens catchers (Fig. 7).
8. Carefully remove the lens from the fixture.

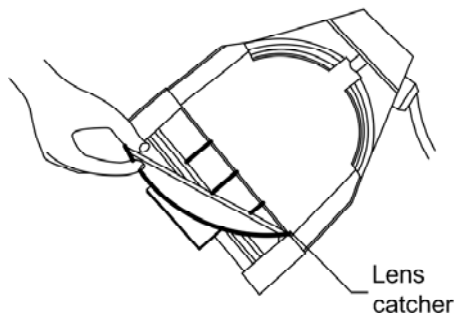

Fig. 7

Color Frame Retaining Clip

The color frame holder is equipped with a spring-loaded retaining clip that prevents color frames and accessories from falling out.

Warning !!! Always hang the Studiobeam with the color frame retaining clip in the locked position.

1. Release the retaining clip by pushing it sideways. The retaining clip opens.
2. Insert the color frame
3. Press the retaining clip down until it locks.

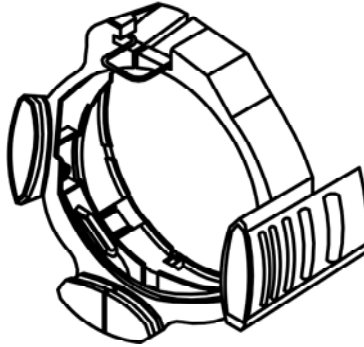

Note: Only use color frames or tophats with a 17 cm diameter.

Set Up and Operation

Follow the directions below, as they pertain to your preferred operation mode.

Before plugging the unit in, always make sure that the power supply matches the product specification voltage. Do not attempt to operate a 120V specification product on 230V power, or vice versa.

Maintenance

The operator has to make sure that safety-relating and machine-technical installations are to be inspected by an expert after every year in the course of an acceptance test.

The operator has to make sure that safety-relating and machine-technical installations are to be inspected by a skilled person once a year.

The following points have to be considered during the inspection:

1. All screws used for installing the device or parts of the device have to be tightly connected and must not be corroded.
2. There may not be any deformations on housings, fixations and installation spots.
3. Mechanically moving parts like axles, eyes and others may not show any traces of wearing.
4. The electric power supply cables must not show any damages or material fatigue.

The Showtec Studiobeam requires almost no maintenance. However, you should keep the unit clean. Otherwise, the fixture's light-output will be significantly reduced. Disconnect the mains power supply, and then wipe the cover with a damp cloth. Do not immerse in liquid. Wipe lens clean with glass cleaner and a soft cloth. Do not use alcohol or solvents.

The front lens will require weekly cleaning, as smoke-fluid tends to build up residues, reducing the light-output very quickly.

Please clean internal components once a year with a light brush and vacuum cleaner.

Keep connections clean. Disconnect electric power, and then wipe the DMX and audio connections with a damp cloth. Make sure connections are thoroughly dry before linking equipment or supplying electric power.

Cleaning the Reflector

Do not use glass and window cleaners on the reflector. Chemicals will damage the reflective coating. **Do not use paper towels or harsh materials to wipe the reflector.** These materials can scratch the surface of the reflectors.

Always disconnect the Studiobeam before cleaning the reflector.

1. Remove the lens to access the reflector from the front of the fixture. See page 8 for removing the lens.
2. Remove dust with a blast of oil-free air, or wipe with a clean, soft, lint-free cotton cloth.
If it is sufficient to only remove dust, go to step 5.
3. Dampen a clean, soft, lint-free cotton cloth with a mild, soapy water solution and gently wipe the reflector.
4. Remove any soapy water residue with a clean, soft, lint-free cotton cloth dampened with water.
5. Reinstall a lens before using the fixture.

Changing the Lamp

If the device is connected to power supply and the lamp is not on, the lamp might need to be replaced. The replacement of the lamp functions as follows:

1. Disconnect from main power supply, and let the Studiobeam cool down for 15 minutes.
2. Loosen the knurled bolt on the back of the lamp housing and pull the housing straight out from the fixture.
3. Follow directions for installing a new lamp, page 7.

Replacing the Fuse

Power surges, short-circuit or inappropriate electrical power supply may cause a fuse to burn out. If the fuse burns out, the product will not function whatsoever. If this happens, follow the directions below to do so.

1. Unplug the unit from electric power source.
2. Insert a screwdriver into the slot in the fuse cover. Gently pry up the fuse cover. The fuse will come out.
3. Remove the used fuse. If brown or unclear, it is burned out.
4. Insert the replacement fuse into the holder where the old fuse was. Reinsert the fuse cover. Be sure to use a fuse of the same type and specification. See the product specification label for details.

Troubleshooting

This troubleshooting guide is meant to help solve simple problems.

If a problem occurs, carry out the steps below in sequence until a solution is found. Once the unit operates properly, do not carry out following steps.

1. If the device does not operate properly, unplug the device.
2. Check the lamps, the fuse, power from the wall, all cables etc.
3. If all of the above appears to be O.K., plug the unit in again.
4. If you are unable to determine the cause of the problem, do not open the Studiobeam, as this may damage the unit and the warranty will become void.
5. Return the device to your Showtec dealer.

No Light

This troubleshooting guide is meant to help solve simple problems. If a problem occurs, carry out the steps below in sequence until a solution is found. Once the unit operates properly, do not carry out following steps.

If the light effect does not operate properly, refer servicing to a technician.

Response: Suspect three potential problem areas: the power supply, the lamp, the fuse.

1. Power supply. Check that the unit is plugged into an appropriate power supply.
2. The lamp. Replace the old lamp with a new one with the same specifications. See page 10 for replacing lamps.
3. The fuse. Replace the fuse. See page 10 for replacing the fuse.

Product Specification

Model: Showtec Studiobeam

Voltage: AC 230V-50Hz (CE)

Power: 600W

Cooling: Ventilator

Dimensions: 300 x 250 x 450 mm (LxWxH)

Weight: 7,0 kg

Lamp

Allowed lamp models*:

Philips MSR 575 (1000 hr; 6000K) ordercode 80915

Osram HSR 575/2 (750 hr) ordercode 80915O

Philips MSR 575 (1000 hr; 7200K) ordercode 80923

*: Versions for other lamps may be produced. Please check the specification label on your product.

Design and product specifications are subject to change without prior notice.





© 2006 Showtec.